

LC-IP Connector & Adapter

GET's LC-IP Connector is designed to provide an outdoor LC-based sealed connection to a board mounted SFP within a sealed enclosure. The system is designed to provide IP67 dust and water protection when connector and receptacle are mated or with dust caps installed. Plug cap includes integrated pulling eye for easy installation. GET's LC-IP assemblies are exceptionally suited for WiMax, LTE, wireless, wireless backhaul and base station applications

LC-IP Connector Plug Type



LC-IP In-line Receptacle Type



LC-IP Bulkhead Receptacle Type



Benefits

- Blind mate and scoop proof interface
- Mates to standard LC simplex or duplex assemblies
- Easily installs without special tooling
- No internal jumper needed
- Direct connect to active device (SFP, SFP+, RJ)

Features

- Bird proof and rodent resistant
- IP67 water and dust protection



- Available with singlemode or multimode fiber
- 50 minimum mating cycles
- Operating temperature: -40° to 85°C
- RoHS compliant
- Bayonet mating style

Applications

- FTTA (Fiber to the Antenna)
- Outdoor Areas
- Harsh Environment
- Wireless
- Small Cells

Specifications

Mode Type	Single Mode	Multi Mode
Insertion Loss, dB	<= 0.15dB(P Grade) , 0.3dB(A grade)	
Return Loss, dB	>= 50dB(PC), 55dB(UPC), 60dB(APC)	
Durability	< 0.2dB change, 50mating	
IP Rating	IP67	
Operating Temperature	-40°C ~ +85°C	

Ordering Information

LC-IP Plug in Factory Installation			
Part Number	Fiber Ferrule ID	Housing Color	
1FA913B001A01	125.5 +1 /- 0 um	Blue	
1FA953B001A01	125.5 +1 /- 0 um	Green	
1FA923B001A01	127 +5 /- 0um	Beige	
1FA933B001A01	127 +5 /- 0um	Aqua	
1FA943B001A01	127 +5 /- 0um	Magenta	
LC-IP In-line Receptacle			
Part Number	Alignment Sleeve	Housing Color	With Shutter
13T122A1A21211201	Ceramic	Blue	Yes
13T222A1A23211201	Ceramic	Green	Yes
13T142A1A22211201	Ceramic	Beige	Yes
13T142A1A24211201	Ceramic	Aqua	Yes
13T142A1A25211201	Ceramic	Magenta	Yes
13T122A1A21212201	Ceramic	Blue	No
13T222A1A23212201	Ceramic	Green	No
13T142A1A22212201	Ceramic	Beige	No
13T142A1A24212201	Ceramic	Aqua	No
13T142A1A25212201	Ceramic	Magenta	No

Tel: 886-7-8139739 Fax: 886-7-8150504

Address: Fl. 3, No. 248-16, Shin Shen Rd., L.E.P.Z. Kaohsiung 806, Taiwan, R.O.C.

WEB: <https://www.gloriole.com.tw> E-Mail: info@gloriole.com.tw

LC-IP Receptacle			
Part Number	Alignment Sleeve	Housing Color	With Shutter
13S122A1A21211201	Ceramic	Blue	Yes
13S222A1A23211201	Ceramic	Green	Yes
13S142A1A22211201	Ceramic	Beige	Yes
13S142A1A24211201	Ceramic	Aqua	Yes
13S142A1A25211201	Ceramic	Magenta	Yes
13S122A1A21212201	Ceramic	Blue	No
13S222A1A23212201	Ceramic	Green	No
13S142A1A22212201	Ceramic	Beige	No
13S142A1A24212201	Ceramic	Aqua	No
13S142A1A25212201	Ceramic	Magenta	No

Applications

LC-IP Connector Plug Type + LC-IP In-line Receptacle Type

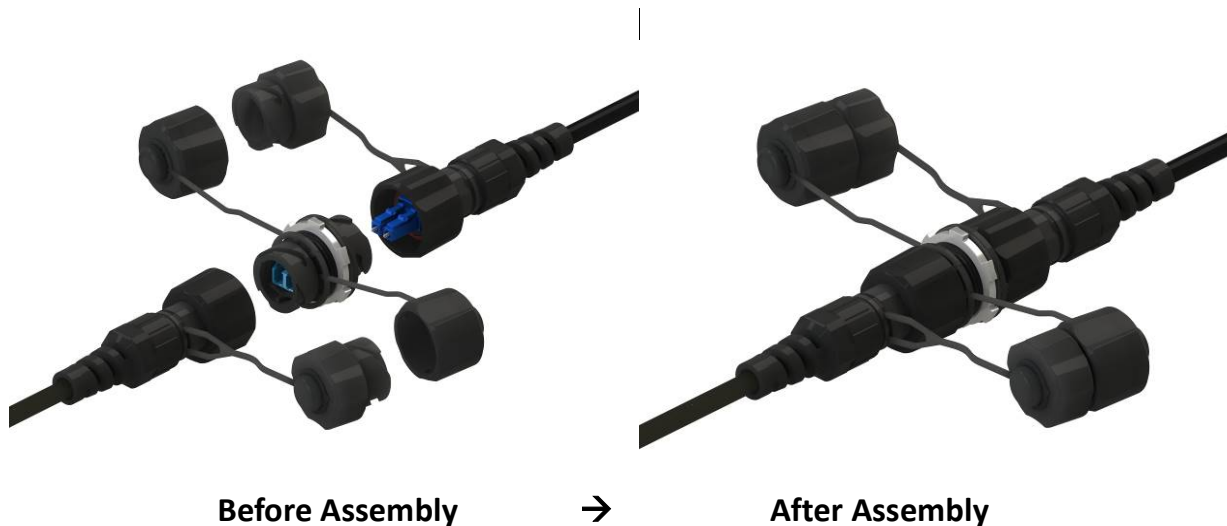

LC-IP Connector Plug Type + LC-IP Receptacle Type

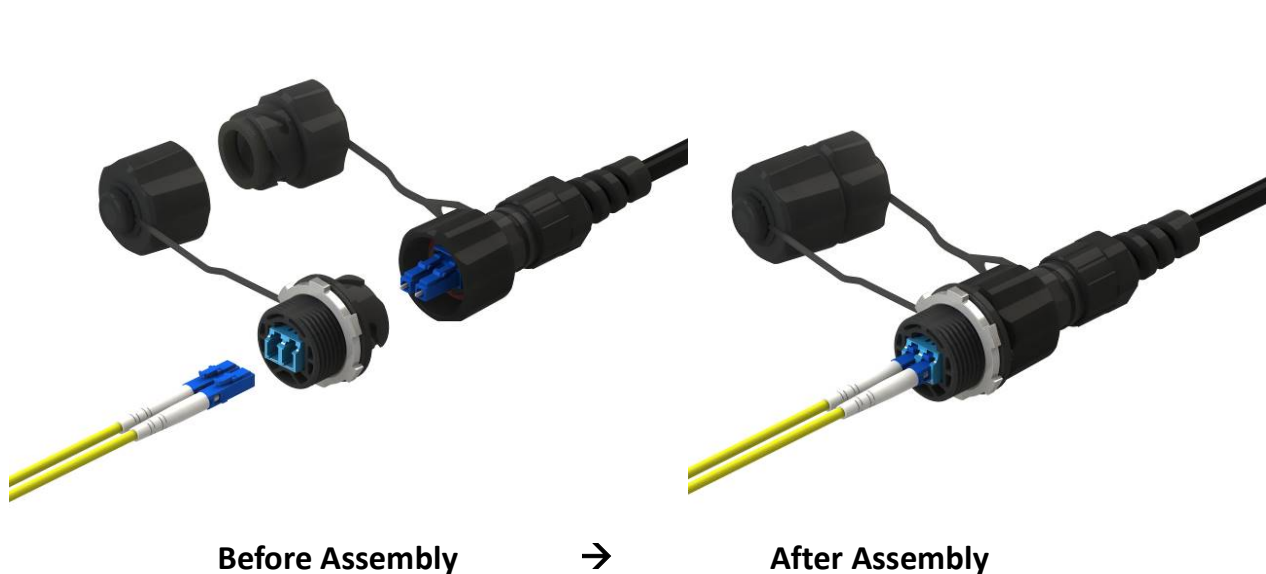

Diagrams

LC-IP Connector Plug in Factory

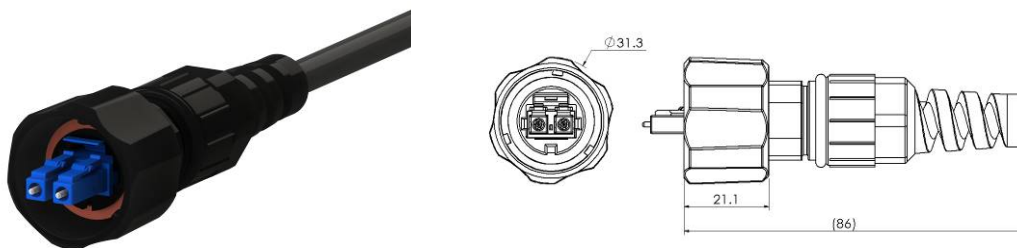

LC-IP Connector Plug in Field

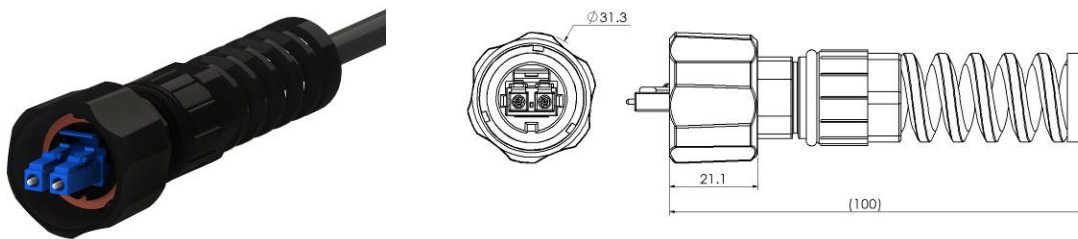

LC-IP In-line Receptacle Type

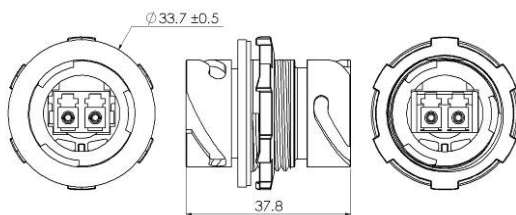

LC-IP Receptacle Type

